

# Absolute - Encoder **CAN-BUS** (Device-Net-Profil) ATD 3B B14 Y14

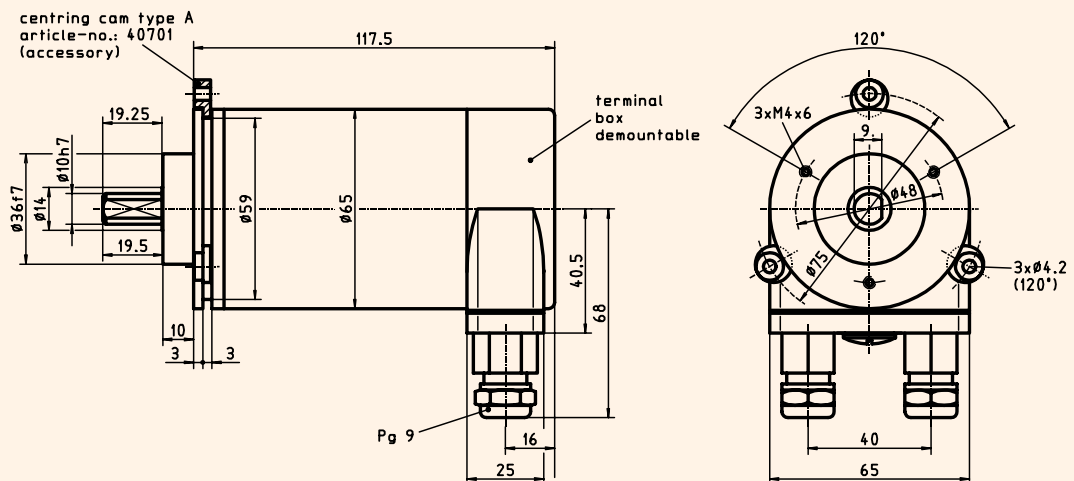

## Qualities:

- Robust, single- resp. Multiturn-Absolute-Encoder
- **Programmable resolution:** up to max. 4096 steps per revolution
- **Programmable resolution:** up to max. 4096 shaft turns ( only multiturn )
- **Programmable zero adjustment:** Preset adjustment
- Centering seat  $\varnothing 36$ , mounting punch circle  $\varnothing 48$
- Execution of interface **CAN - BUS** (Device-Net-Profil)
- Terminal-box detachable

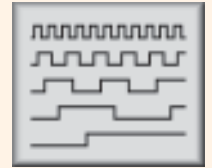

ATD 3.. B14 Y14

drawing-no.: 026 - 31 Y14

## Mechanical data:

Housing		light-alloy metal, black	
Design style	<b>B14</b>	B14	
Protective class	<b>IP65</b>	IP 65	according to DIN 40 050, IEC 529
Construction principle		LED with glas slotdisc	
max. speed ( mechanical )	$n_{max}$	$\leq 6000$ rpm	
Admissible shaft load	axial	$\leq 40$ N	
	radial	$\leq 60$ N	( at shaft end )
Starting torque	at 20 ° C	$\leq 2$ Ncm	
Vibration	55... 2000 Hz	$\leq 100$ m/s <sup>2</sup>	according to DIN IEC 68, Teil 2-6
Shock	11 ms	$\leq 1000$ m/s <sup>2</sup>	according to DIN IEC 68, Teil 2-27
Moment of inertia ( rotor )		approx. 25 gcm <sup>2</sup>	
Shaft diameter	d	10 mm	
Weight		approx. 700 g	

# Absolute - Encoder **CAN-BUS** (Device-Net-Profil) ATD 3B B14 Y14



## Electrical data:

• Steps per revolution	<i>Single- / Multiturn</i>	<b>XX</b>	4096 ( 12 Bit ) steps per revolution
• Anzahl der Umdrehungen	<i>Multiturn</i>	<b>YY</b>	4096 ( 12 Bit ) shaft turns
• Interface-driver			CAN - wire remote bus interface
• Data transmission		<b>CB</b>	CAN-BUS driver ( ISO / DIS 11898 )
		<b>DN</b>	Device-Net-Profil
Baud-rate			125 kBaud, up to 500 m cable length 250 kBaud, up to 250 m cable length 500 kBaud, up to 100 m cable length
Stationaddress			0 to 63 with decade switch ajustable
Supply voltage:	$U_B$		11 - 27 VDC
Loss efficiency (no load)	$P_{max}$		≤ 4 Watt
• Type of connection		<b>2xPG9</b>	detachable outlet with 2 x Pg 9, radial
• Abschlußwiderstand			123 Ω, terminating enabled about switching device
• Operating temperature range		<b>S</b>	0 °C to + 60 °C

## Options:

- options upon request

## Accessories:

Centring cam-set type A ( 3 pcs. )

article-no.: 40701-3

## Connection table:

**PIN - no.**      **signals**

### X1 - solderless lug 2-poles

PIN 1 = CAN\_+  $U_B$  (internally NC)

PIN 2 = CAN\_0 V

### X2 - solderless lug 2-poles

PIN 1 = CAN\_H

PIN 2 = CAN\_L

### X3 - solderless lug 2-poles

PIN 1 = shilding

PIN 2 = shilding

### X4 - solderless lug 2-poles

PIN 1 = CAN\_L

PIN 2 = CAN\_H

### X5 - solderless lug 2-poles

PIN 1 = CAN\_0 V

PIN 2 = CAN\_+  $U_B$  (internally NC)

### X6 - solderless lug 2-poles

PIN 1 = +  $U_B$

PIN 2 = 0 V

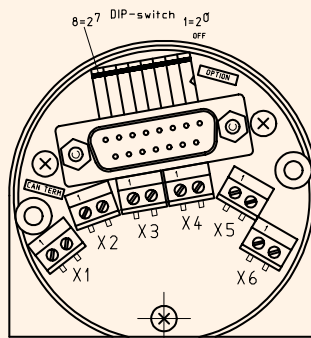

DIP-switch 8	DIP-switch 7	Baud-rate
off	off	125 kBaud
off	on	250 kBaud
on	off	500 kBaud

DIP 6	...	DIP 1	Stationaddress
off	...	off	0
off	...	on	1
...	...	...	...
on	...	on	63

## Ordering example:

<b>ATD 3B</b>	<b>B14</b>	<b>Y14</b>	<b>12/12</b>	<b>CB</b>	<b>DN</b>	<b>2xPG9</b>	<b>S</b>	<b>10</b>	<b>IP65</b>
Absolut-Encoder ATD 3B	Design style B14	Mechanical variante Y14 = look at the drawing	Steps / rev. / no. of turn 4096 ( 12 Bit ) steps/rev. 4096 ( 12 Bit ) rev.	Datatransmission CAN-BUS	Datatransmission D evice-Net-Profil	Type of connection outlet with 2 x Pg 9, radial	Operating temperature 0 °C to +60 °C	Shaft diameter 10 mm	Protective class IP 65