

DC tachogenerator

KTD 2-... A 4 KA



Qualities:

- High reaction rate
- Large speed range
- Recognition of rotational direction
- Small percent ripple
- No power supply

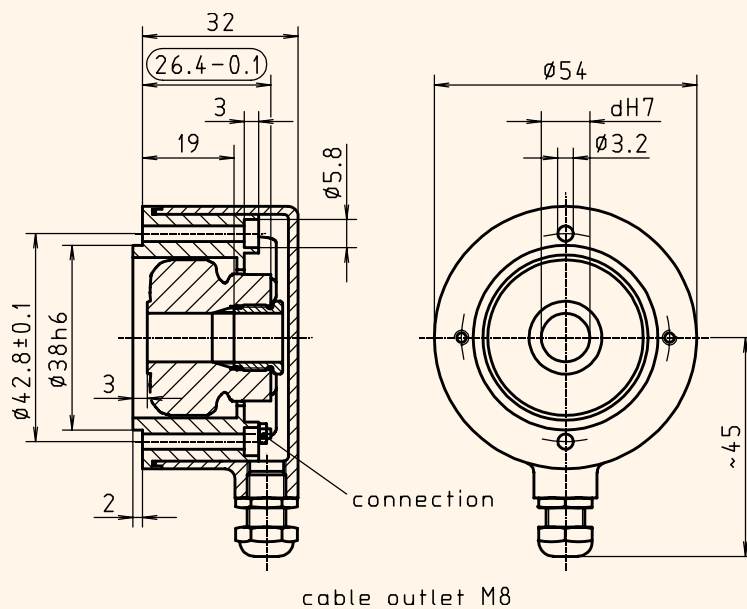
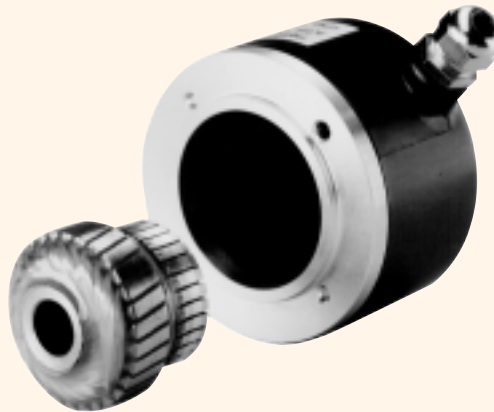

KTD 2-... A 4 KA KSE

drawing-no.: 023 - 6

Rotor attachment:

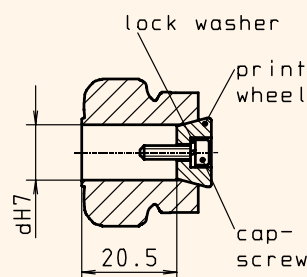

DS

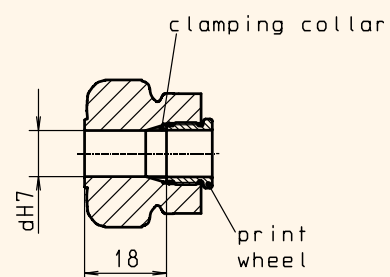

KSE

DC tachogenerator

KTD 2-... A 4 KA



Mechanical data:

Housing		plastic, black
Design style		A 4
Protective class		IP 55 <i>according to DIN 40 050, IEC 529</i>
Upper speed limit		n_{max} 8000 rpm
Bore diameter		d 10 mm (standard) (8 - 12 mm possible)
Rotor attachment	DS	axial over print wheel (standard)
Massmoment of inertia		J 80 gcm ²
Weight	<i>housing</i>	approx. 130 g
	<i>rotor</i>	approx. 60 g

Electrical data:

referenced to 1000 rpm

Type	Rated voltage [V]	Rated current [mA]	max. current [mA]	Load resistance [kOhm]	Amature winding [Ohm]
KTD 2-0,7	7	2,1	40	3,3	60
KTD 2-1 ...	10	1	25	10	85
KTD 2-1,5 ...	15	1	15	15	345

Polarity		dependent on rotational direction
Number of pole pair		2 = 4 - poles
Number of grooves, segments		29
Grooves frequency		$f_N = 29 / 30 * n$
Reversing error		≤ 0,4 %
Residual ripple		≤ 0,6 %
Linearity error		≤ 0,15 %
Regulation range lower limit		n_R 0 rpm
Temperature drift (- 10 °C to + 100 °C)		± 0,2 % / 10 K
Type of connection		screw terminal, 2-poles
Isolation class		B
Carbon brushes		4 pieces AG 3,2 x 4 x 10
Carbon brushes life		approx. 40.000 hours of operation

Options:

- Cable - version (2 x 0,5 mm²)
- Rotor attachment *KSE* cone clamping collar
- Silver track in the collector
- Bore diameter d 8 mm, 9 mm, 11 mm, 12 mm